

top projects
2002
#21 tie

PALMQUIST DEVELOPMENT HIGH SCHOOL AND ELEMENTARY SCHOOL

Gresham

Andersen Construction Co. was hired as the construction manager/general contractor to build three new buildings for the Gresham-Barlow School District. The Palmquist Development is a 27-acre site consisting of a new 42,000-square-foot alternative high school, a 62,000-square-foot elementary school and a 24,000-square-foot maintenance and operations building with related site work including new roads, site utilities, sports fields and playgrounds. The fast-track project is being delivered to the client within nine months.

top projects
2002
#21 tie

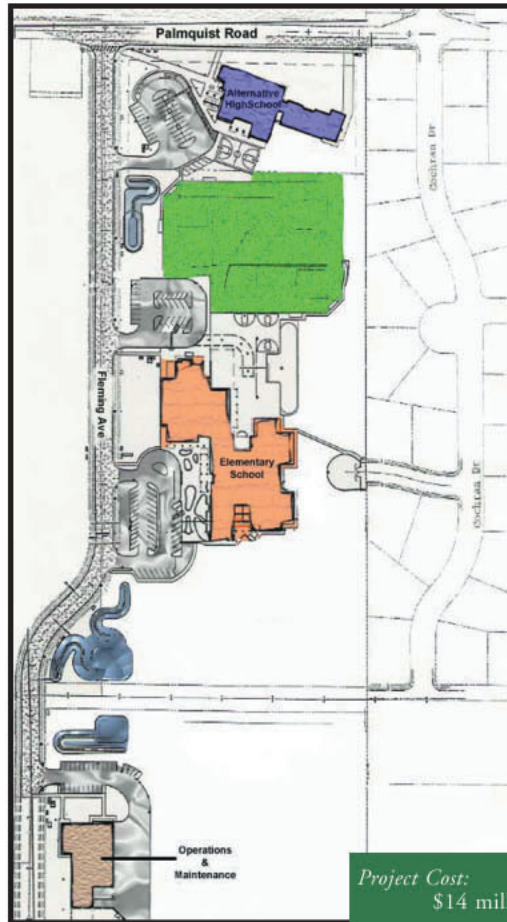

Rendering courtesy of LSW Architects

Project Cost:
\$14 million
Sitework Start:
August 2001
Completion:
September 2002
Peak Construction Employment:
150

General Contractor:
ANDERSEN CONSTRUCTION CO.
6712 N. Cutter Circle
Portland, OR 97217
www.andersen-const.com

Owner:
Gresham-Barlow School
District

**Owner's Representative/
Project Manager:**
Milstead & Associates Inc.

Project Managers:
Jerry Isgro, Greg Martin

Project Superintendents:
Dan Bott, Paul Hesheth

General Foreman:
Ron McMasters

Project Coordinators:
Greg Nourse, Bob Parshall, Perry Smick

High School/Maintenance Building Architect:
LSW Architects Inc.

Elementary School Architect:
Dull Olson Weekes Architects PC

High School/Maintenance Building Engineers:
Conlee Engineers Inc., Interface
Engineering Inc., MKE & Associates, SJO
Consulting Engineers

Elementary School Engineers:
CBG Consulting Engineers, James G. Pierson Inc., SJO Consulting Engineers

Other Associates:
Architectural Cost Consultants, Halliday Associates, Percival & Shapiro

Subcontractors: Overall Project: B&B Masonry, Basic Fire Protection, Cherry City Electric, Crawford Electric, Hydro-Temp Mechanical, Moore Excavating, Prairie Electric, Teufel Nursery Inc., Willamette Masonry. Elementary School: Architectural Metalcrafters Inc., Arrow Roofing & Sheetmetal, Basic Fire Protection, Benson Industries, Bob Carlson Roofing and Sheet Metal, Cherry City Electric, Crawford Roll-Lite Door, Curtis Restaurant Equipment Co., Entrance Controls Inc., Graham Steel, Dan Hunt & Associates Inc., Hydro-Temp Mechanical, Insta-Fab Inc., Mountain Glass, Northern Hardwood Co., Rubenstein's Contract Carpet, Schindler Elevator, Trus Joist, Vancouver Roofing & Sheetmetal, W.B. Painting, Washington Architectural Hardware, Whitaker Ellis, Willamette Masonry